

Ordering code

6500.Ø.stroke. 1 . M

- 10
- 16
- 20
- 25



Construction characteristics

Body	oxidised aluminium alloy
Piston rod	stainless steel
Piston	brass
Rods bushing	sinterize bronze
End plate	aluminium
Cushioning washer	PUR
Seal	oil resistant NBR rubber

Technical characteristics

Fluid	filtered and non lubricated air
Minimum working pressure	0.6 bar (for bore Ø10 - Ø16) 0.5 bar (for bore Ø20 - Ø32)
Max pressure	7 bar
Operating temperature	-5°C - +70°C
Cushioning	with elastic bumper
Stroke tolerance	+1 / 0 mm
Piston speed	50 - 500 mm/sec (without load)

Standard strokes

Bore	Stroke							
	5	10	15	20	25	30	40	50
Ø10	●	●	●	●	●	●		
Ø16	●	●	●	●	●	●		
Ø20	●	●	●	●	●	●	●	●
Ø25	●	●	●	●	●	●	●	●

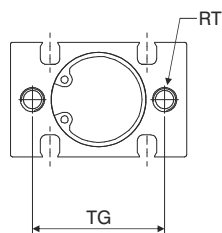

*Ø10: n° 2 piston rod nuts
Ø16: n° 1 piston rod nut

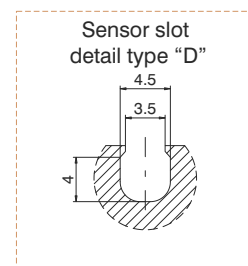
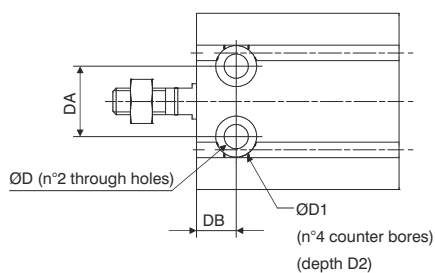
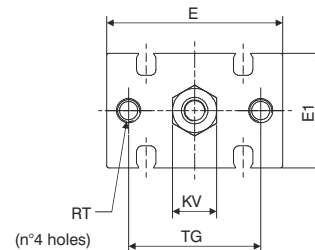
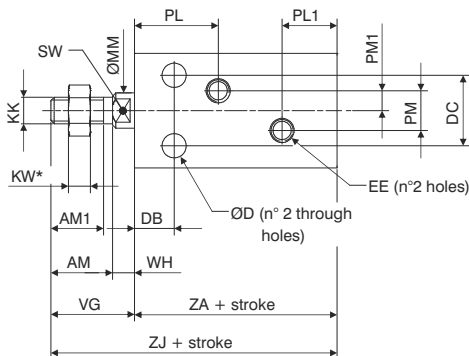

Table of dimensions

	Bore			
	Ø10	Ø16	Ø20	Ø25
AM	/	12.5	14	18
AM1	10	11	12	15.5
ØD	Ø3.2	Ø4.5	Ø5.5	Ø5.5
ØD1	Ø6	Ø7.6	Ø9.3	Ø9.3
D2	5	6.5	8	9
DA	11	14	16	20
DB	7	7	9	10
DC	9	12	16	20
E	24	32	40	50
E1	15	20	26	32
EE	M5	M5	M5	M5
KK	M4	M5	M6	M8
KV	7	8	10	13
KW	3	4	5	5
ØMM	Ø4	Ø6	Ø8	Ø10
PL	16.5	16.5	19	21.5
PL1	10	11.5	12.5	13
PM	/	4	9	9
PM1	/	2	4.5	4.5
RT	M3 (Useful dept 5)	M4 (Useful dept 6)	M5 (Useful dept 8)	M5 (Useful dept 8)
SW	/	5	6	8
TG	18	25	30	38
VG	16	16	19	23
WH	/	3.5	5	5
ZA	36	40	46	50
ZJ	52	56	65	73
Weight (gr.)				
Stroke 0	32	44	84	159
every 5 mm	4	6	11	17