

**Construction characteristic**

|                 |   |
|-----------------|---|
| End covers      | Nylon 66 reinforced with glass fibres   |
| Barrel          | Nylon 66 reinforced with glass fibres   |
| Piston rod      | C43 Chromed (non magnetic piston version)<br>Stainless steel AISI 303 chromed (magnetic piston version) |
| Piston          | Alluminium  |
| Seal            | NBR oil-resistant rubber seal   |
| Piston rod seal | Polyurethane self-lubricated mix  |
| Mounting        | Steel painted / stainless steel AISI 304  |
| Forks           | Zinc plated steel / stainless steel AISI 304  |

**Technical characteristic**

|                          |   |
|--------------------------|---|
| Fluid                    | Filtered air lubricated or non-lubricated |
| Maximum working pressure | 8 bar                                     |
| Working temperature      | -5°C ÷ +50°C                              |

**Standard stroke**

**ø 12**

15 - 25 - 50 - 75 - 80 - 100 - 125 - 150 - 160 - 200 mm

**ø 16**

15 - 25 - 50 - 75 - 80 - 100 - 125 - 150 - 160 - 200 - 250 mm

**ø 20 et ø 25**

15 - 25 - 50 - 75 - 80 - 100 - 125 - 150 - 160 - 200 - 250 - 300 mm

**Maximum tightening torque for fittings**

| Bore | Thread | Maximum torque (Nm) |
|------|--------|---------------------|
| Ø 12 | M5     | 1                   |
| Ø 16 | M5     | 1                   |
| Ø 20 | G 1/8" | 4                   |
| Ø 25 | G 1/8" | 4                   |

**WEIGHT TABLE SERIES TECNO MIR 1230 - 1231**

|            |           | BORE     |        |         |         |
|------------|-----------|----------|--------|---------|---------|
|            |           | Ø12      | Ø16    | Ø20     | Ø25     |
| WEIGHT gr. | stroke 0  | 50 gr.   | 65 gr. | 120 gr. | 160 gr. |
|            | for 10 mm | 3,75 gr. | 4 gr.  | 6,5 gr. | 9 gr.   |

**WEIGHT TABLE SERIES TECNO MIR 1232**

|            |           | BORE   |         |         |         |
|------------|-----------|--------|---------|---------|---------|
|            |           | Ø12    | Ø16     | Ø20     | Ø25     |
| WEIGHT gr. | stroke 0  | 60 gr. | 75 gr.  | 180 gr. | 200 gr. |
|            | for 10 mm | 7 gr.  | 8,5 gr. | 10 gr.  | 20 gr.  |

### Basic version

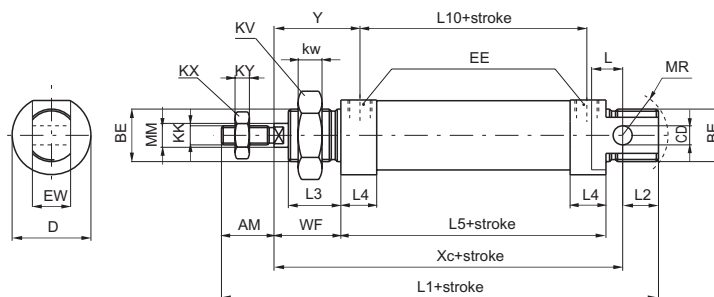

Standard version, fully complying with ISO standards. Can use all available mountings.

| Ordering code          | Description            |
|------------------------|------------------------|
| <b>1230.Ø.stroke</b>   | Basic version          |
| <b>1230.Ø.stroke.M</b> | Magnetic basic version |

### Without rear eye version

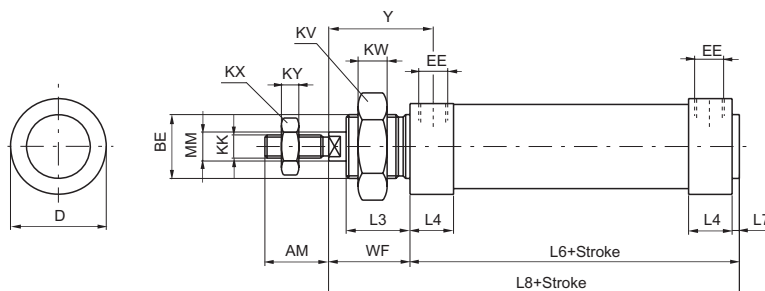

This version derived from standard version 1230 and not included in ISO standard.

Not having a rear eye it is shorter. The inlet connection is lateral on the rear cover (like on the front cover).

| Ordering code          | Description            |
|------------------------|------------------------|
| <b>1231.Ø.stroke</b>   | Basic version          |
| <b>1231.Ø.stroke.M</b> | Magnetic basic version |

### Push/Pull rod version

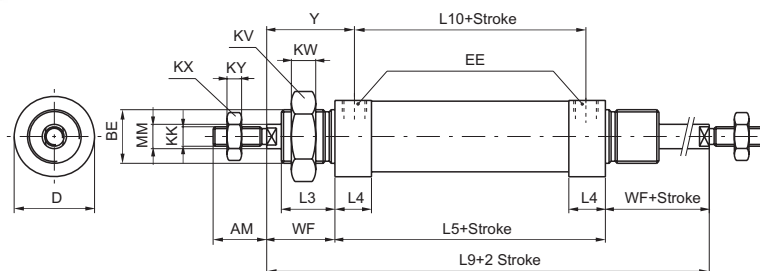

Through rod model, dimensions as per the 1230 (except the rod).

| Ordering code          | Description            |
|------------------------|------------------------|
| <b>1232.Ø.stroke</b>   | Basic version          |
| <b>1232.Ø.stroke.M</b> | Magnetic basic version |

**Table of dimensions**

|           | Bore    |         |         |          |
|-----------|---------|---------|---------|----------|
|           | 12      | 16      | 20      | 25       |
| AM (-0,2) | 16      | 16      | 20      | 22       |
| BE        | M16X1,5 | M16X1,5 | M22X1,5 | M22X1,5  |
| CD (H9)   | 6       | 6       | 8       | 8        |
| D (h11)   | 19      | 23      | 28,5    | 31,5     |
| EE        | M5      | M5      | G1/8"   | G1/8"    |
| EW (d13)  | 12      | 12      | 16      | 16       |
| KK (6g)   | M6X1    | M6X1    | M8X1,25 | M10X1,25 |
| KV        | 22      | 22      | 30      | 30       |
| KW        | 6       | 6       | 7       | 7        |
| KX        | 10      | 10      | 13      | 17       |
| KY        | 4       | 4       | 5       | 6        |
| L         | 9       | 9       | 12      | 14       |
| L1(±1)    | 105     | 111     | 130     | 140      |
| L2        | 14      | 13      | 15      | 14       |
| L3        | 17      | 17      | 18      | 22       |
| L4        | 13,5    | 14,5    | 20,5    | 20       |
| L5 (±1)   | 50      | 56      | 68      | 68       |
| L6        | 52      | 58      | 70,5    | 70,5     |
| L7        | 2       | 2       | 2,5     | 2,5      |
| L8        | 74      | 80      | 94,5    | 98,5     |
| L9 (±1,2) | 94      | 100     | 116     | 124      |
| L10 (±1)  | 41      | 45      | 52      | 52       |
| MM (f7)   | 6       | 6       | 8       | 10       |
| WF (±1,2) | 22      | 22      | 24      | 28       |
| XC (±1)   | 75      | 82      | 95      | 104      |
| Y (±1)    | 26,5    | 27,5    | 32      | 36       |